

SXC5-6.3

Insulated Metal Panel Attachment

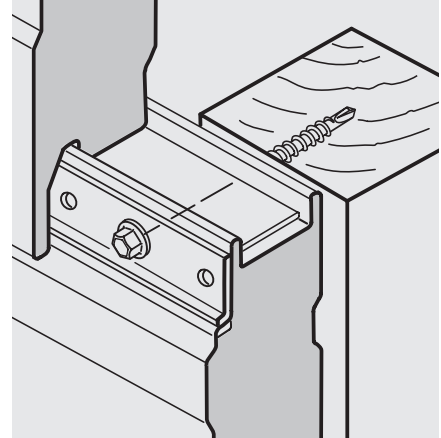
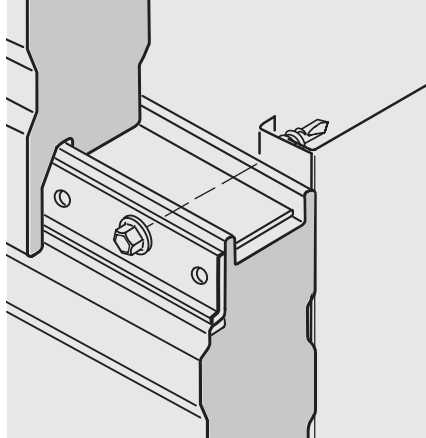

Features and Benefits

- 304 Stainless steel bi-metal provides maximum corrosion resistance while being able to drill steel substrates. 316 Stainless steel is available by request.
- Perfect supporting of the IMP outer-skin given by support thread with cut-off thread-end
- Optimized support function achieved by engineered double support thread
- Easy drilling through overlapped metal profiles given by the long drill point
- High bending capacity for absorption of thermal expansion of the IMP outer-skin
- High tension resistance achieved by optimized fastener geometry

Application

- Insulated metal panel (IMP) to metal or wood
- Concealed or face fastened

Features and Benefits continued

- Upgraded major diameter requires less fasteners for the project, and saves installation time due to not needing to pre-drill the application
- Color matched Vista spray available to blend with facade panel

Approvals



Product Selection

Material No.	Fastener Length		Load Bearing Length		Thread Length		Description	Carton Wt. (lbs.)	Carton Qty.
	(in)	(mm)	(in)	(mm)	(in)	(mm)			
1599843	3-1/8	80	2-1/4	58	1-7/8	48	SXC5-6,3×80-A2	3.2	100
1599844	3-15/16	100	3-1/16	78	2-1/4	58	SXC5-6,3×100-A2	3.8	100
1599847	4-3/4	120	3-7/8	98	2-11/16	68	SXC5-6,3×120-A2	4.5	100
1599848	5-1/2	140	4-5/8	118	2-11/16	68	SXC5-6,3×140-A2	5.2	100
1599851	6-5/16	160	5-7/16	138	2-11/16	68	SXC5-6,3×160-A2	5.9	100
1599857	7-1/2	190	6-5/8	168	3-1/16	78	SXC5-6,3×190-A2	6.9	100
1599859	8-11/16	220	7-13/16	198	3-1/16	78	SXC5-6,3×220-A2	7.9	100
1599860	9-13/16	250	9	228	3-1/16	78	SXC5-6,3×250-A2	9.0	100
1599871	11-7/16	290	10-9/16	268	3-1/16	78	SXC5-6,3×290-A2	10.0	100

Dimensions in inches are approximate conversions.

Note: Fasteners are available with stainless bond seal washer. Inquire with SFS about availability.

US
T 800 234 4533
us.sfs.com

Canada
T 866 847 5400
ca.sfs.com

Metric values are approximate conversions.

All information is non-binding and without guarantee. Before using the products, all specifications and calculations must be checked by a suitably qualified person and local regulations must be observed. This document is subject to revision. We reserve the right to make technical changes. (12/2023, V1.02)

SXC5-6.3

Insulated Metal Panel Attachment

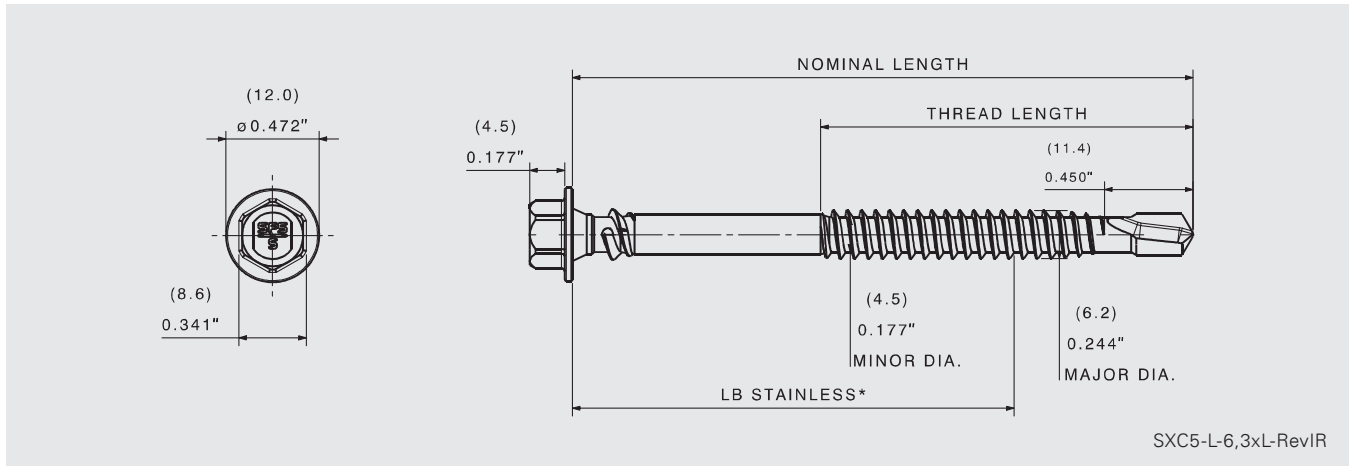

Product Specifications

Diameter: Nominal #14 (6.3 mm)
 Threads Per Inch: 14
 Head Style: 5/16" HWH AF (8.0 mm)
 Material: 304SS

Drill Point: SD3
 Drill Capacity: 0.048"–0.157" (1.25 mm–4.0 mm)
 Thread Major Dia: 0.248" (6.3 mm)
 Thread Minor Dia: 0.177" (4.5 mm)

Performance Data^{1,2}

Material Strength

Tensile	2650 lbf / 11788 N
Shear	2227 lbf / 9906 N
Torsional	120 lbf-in / 13.6 N·m

Pull Out Strength Steel

16 Ga (1.5 mm)	611 lbf / 2718 N
14 Ga (1.9 mm)	1055 lbf / 4693 N
12 Ga (2.7 mm)	1652 lbf / 7348 N
9 Ga (3.8 mm)	2623 lbf / 11668 N

Pull Over Strength*

26 Ga (0.5 mm):	474 lbf / 2110 N
24 Ga (0.6 mm):	683 lbf / 3040 N

¹ SFS 5641.19

² ETA 13/0183

* with 19 mm washer

Installation and Application Considerations

Fasteners should provide for a minimum of 3 fully developed threads through the metal substrates.

Tools: 0–2000 rpm screw gun equipped with depth sensing nose piece

Use of impact guns or hammer drills is not recommended.